

CENTRAL AVENUE

GROUND FLOOR PLAN / SITE LAYOUT

FIRST FLOOR PLAN

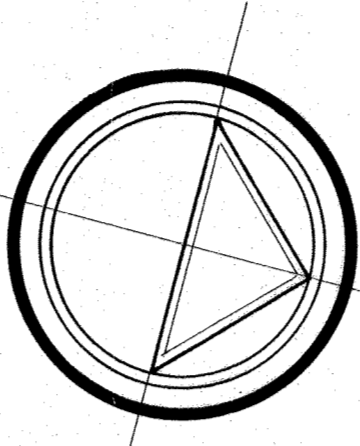
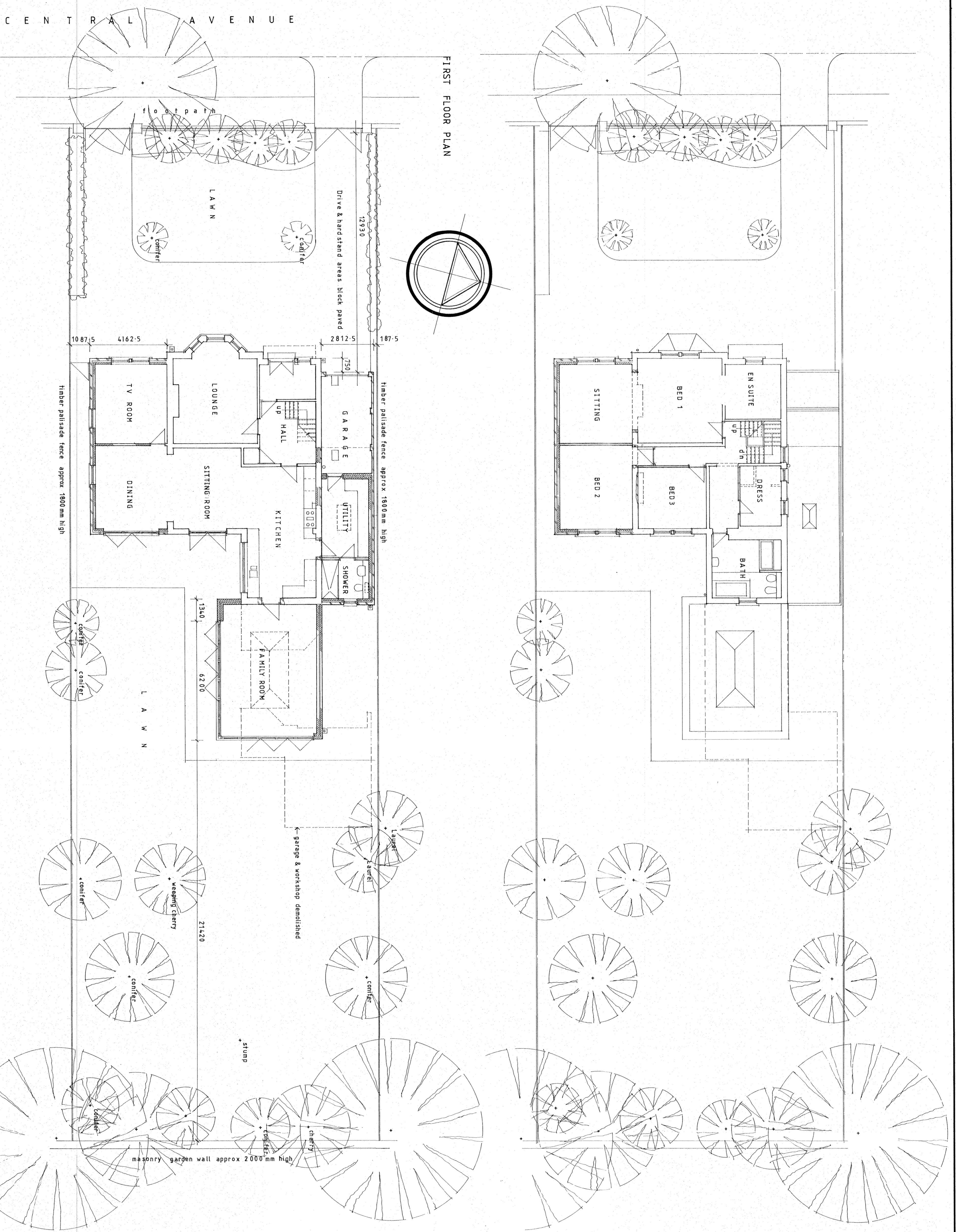

**AMENDED**  
**PLAN**

AMENDMENTS  
A 23.06.15  
Layout to Family Room, garage, utility & shower  
revised

SOUTH TYNESIDE COUNCIL  
25 JUN 2015  
AREA PLANNING

ST0396/15 HFUL

GROUND & FIRST FLOOR PLANS  
AS PROPOSED

GRAY o FAWDON + RIDDLE ARCHITECTS  
THE QUARUS CENTRE • WOODSTOCK WAY • BOLDON BUSINESS PARK W.E.35 9PP • TEL: 0191 74 60

1 : 100	589 / SK 1A	A 13 / 15
---------	-------------	-----------